

FED. ROAD DIST.	STATE	FED. AID PROJ. NO.	FISCAL YEAR	ROUTE	POST-MILE
7	KY.				

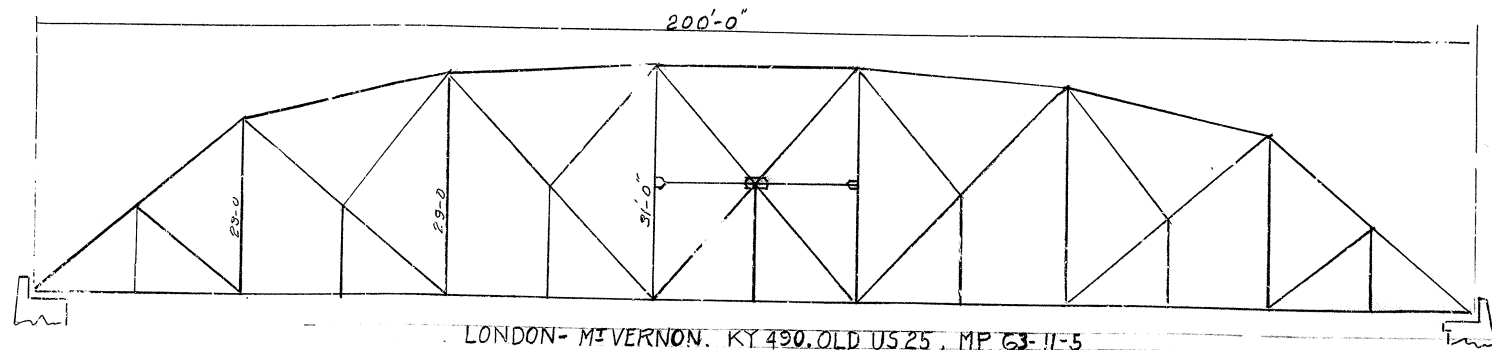

LONDON-McVERNON, KY 490. OLD US 25, MP 63-11-5  
 ESTIMATED WEIGHT OF STEEL TO BE PAINTED 175.5 TONS  
 BRIDGE OVER ROCKCASTLE RIVER

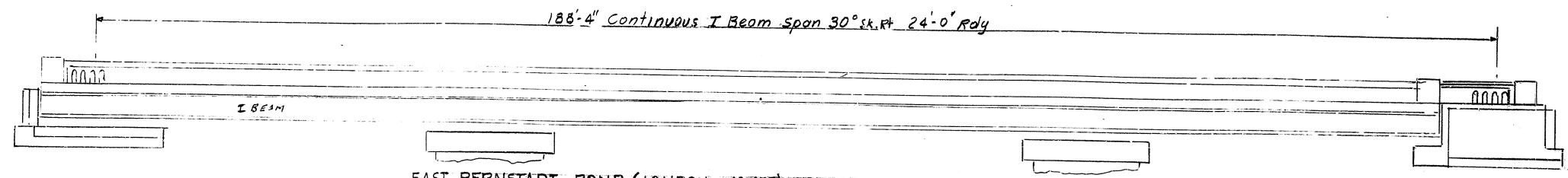

188'-4" Continuous I Beam span 30' sk. ft. 24'-0" Rdy  
 I BEAM  
 EAST BERNSTADT-BOND (LONDON-McKEE) MP 63-31-2  
 BRIDGE OVER ROCKCASTLE RIVER  
 ESTIMATED WEIGHT OF STEEL TO BE PAINTED 104.0 TONS

GENERAL NOTE

REQUIREMENTS: KENTUCKY DEPARTMENT OF HIGHWAYS, 1956 STANDARD SPECIFICATIONS WITH AMENDMENTS.  
 CLEANING AND PAINTING: ALL STRUCTURAL STEEL SHALL BE CLEANED ACCORDING TO 5-2-2-3-1 OF THE SPECIFICATIONS AND GIVEN ONE COAT OF TYPE I RED LEAD PAINT (SEE SEC. 7-23.1-4) AND ONE COAT OF ALUMINUM PAINT. THE COMPLETION DATE OF PAINTING (YEAR AND MONTH) SHALL BE SPECIFIED ON THE STRUCTURE AS DIRECTED IN THE NOTES. LETTERS OR FIGURES SHALL BE TWO (2) INCHES HIGH AND THE PAINT SHALL CONTRAST WITH THE BACKGROUND. ALL CLEANING AND PAINTING WORK AS COVERED BY THIS AND SPECIFICATIONS SHALL BE INCLUDED IN THE UNIT PRICE BID FOR CLEANING AND PAINTING.  
 APPLICATION: ALL PAINT SHALL BE APPLIED WITH BRUSHES IN ACCORDANCE WITH THE SPECIFICATIONS. THE CONTRACTOR SHALL BE RESPONSIBLE FOR ANY AND ALL DAMAGES CAUSED BY PAINTING OR REPAINTING OF THE STRUCTURE, VEHICLES, FERRIS WHEELS OR AIRCRAFT PROPERTY DURING THE PROCESS OF PAINTING.  
 REMARKS: THE UNIT PRICE BID FOR PAINTING SHALL BE FULL COMPENSATION FOR ALL MATERIALS, TOOLS, SUPPLIES, SOLWELDING, LABOR AND INCIDENTALS FOR THE WHITE PAINTED CONTRACT. PARTIAL PAYMENTS WILL BE MADE ON MONTHLY ESTIMATES AS THE WORK PROGRESSES ON THE BASIS OF 50% OF THE CONTRACT LUMP SUM PRICE WHEN THE WHITE STRUCTURE IS CLEANED AND A COMPLETE PRIME COAT OF TYPE I RED LEAD PAINT HAS BEEN SATISFACTORILY APPLIED TO THE WHITE STRUCTURE AND 50% OF THE LUMP SUM CONTRACT PRICE WHEN ONE COMPLETE COAT OF ALUMINUM PAINT HAS BEEN SATISFACTORILY APPLIED TO THE WHITE STRUCTURE. WITH THE PROVISION THAT 10% OF EACH PAYMENT WILL BE RETAINED ON ALL ESTIMATES EXCEPT THE FINAL ESTIMATE.

TOTAL ESTIMATE OF QUANTITIES	
M.P. NUMBER	CLEANING & PAINTING EXISTING STEEL
63-11-5	1 EACH
63-31-2	1 "

COMMONWEALTH OF KENTUCKY  
 DEPARTMENT OF HIGHWAYS  
 FLEMING COUNTY  
 COUNTY OF  
 LAUREL  
 M.P. 63-11-5      M.P. 63-31-2

STATION	PROJECT NO.
BRIDGE NUMBER (63-11-5)(63-31-2)	13205

DESIGNED BY	DATE	REVISION
CHECKED BY	DATE	REVISION
APPROVED BY	DATE	REVISION